

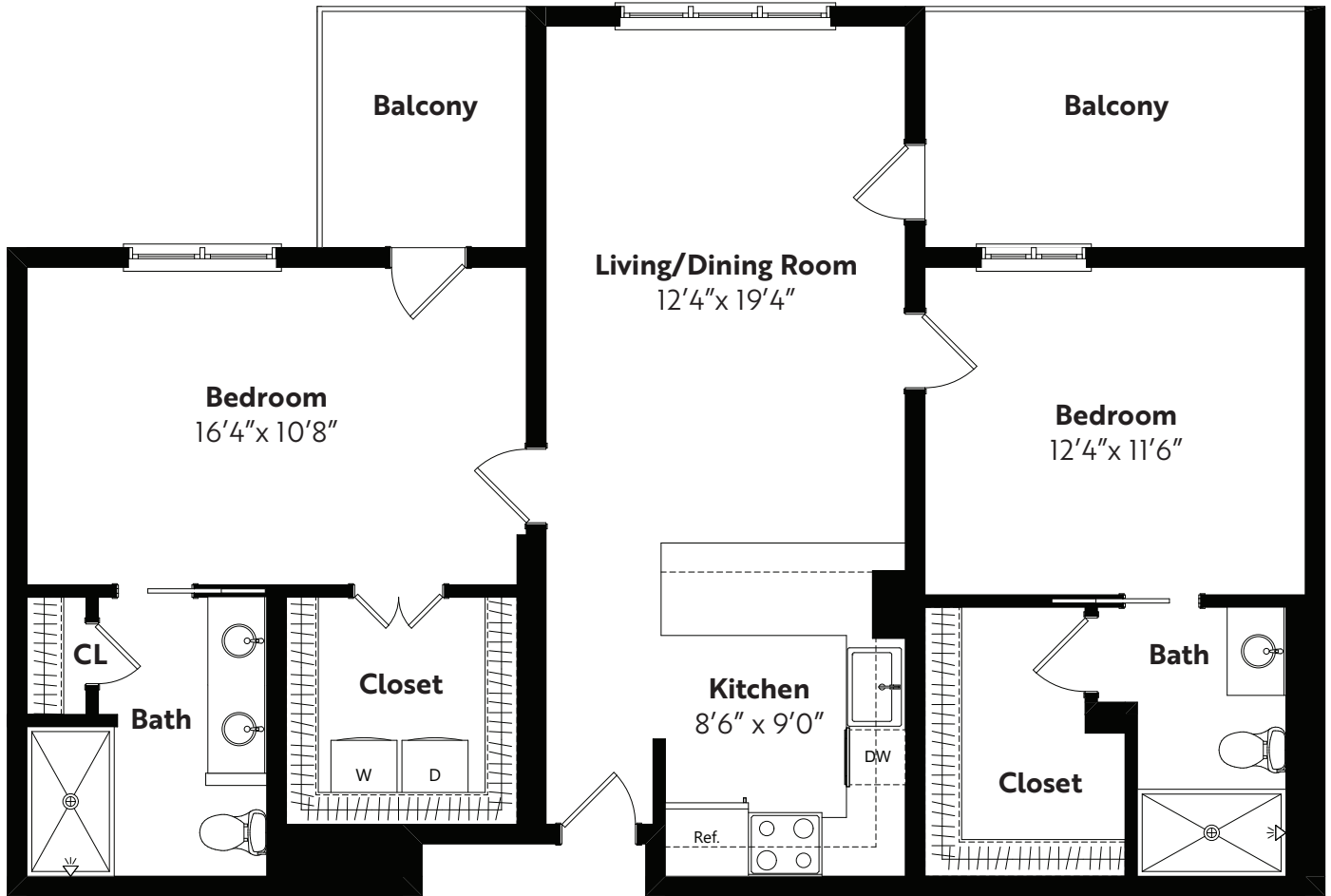

**BROOKRIDGE**  
A THRIVEMORE COMMUNITY

# Cedar

2 BEDROOM, 2 BATH APARTMENT • 1,050 SQ. FT.



View all plans by visiting  
[BrookridgeCommunity.org/floor-plans](https://BrookridgeCommunity.org/floor-plans)

*All dimensions are approximate.*

1199 HAYES FOREST DRIVE • WINSTON-SALEM, NC 27106

